



Lighting made from a sheet
JELLYFISH LIGHT



Attach the buttons to the ends of rectangular sheet. In order, fasten those buttons of each ends. Then, the rectangle becomes a sphere while making soft folds. I named this light with soft folds “JELLYFISH LIGHT”



Chair made from a sheet
SCARF CHAIR



Cut out a pentagonal form from a planar vinyl shaped like semicircle. The pentagon becomes the seat surface, and the remaining part morphs into legs of the chair, inevitably. I named this light chair made from a plane surface "SCARF CHAIR."





Magazine rack made from a sheet
BRICK RACK

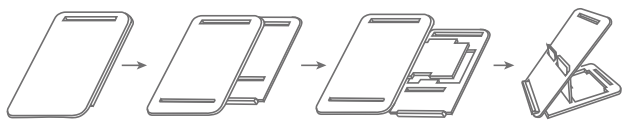

Just the right style when needed. This is a magazine rack to put away easily and frequently. It's will fulfill your ideal storage.

